

標準接頭 (黑) Tube Fitting (Black)

PMF
G

分隔內牙直型
Bulkhead Female Straight

\$ P03

3D
CAD

2D
CAD

單位(Unit): m/m

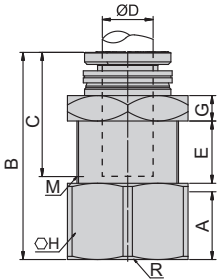

Model 型式	Tube dia. ØD 管外徑	A	E	G	B	C	M	H	R	Mass(g) 重量	Orifice 流量孔徑
PMF4-01G	4	8	5.9	4	25.2	12.4	M12X1.0	14	G1/8	18.8	3
PMF6-01G	6	9	7.8	4	28.8	14.3	M14X1.0	17	G1/8	29.5	4.8
PMF6-02G		10	7.8		29.8				G1/4	29	
PMF8-01G	8	9	9.8	4	31.6	18.3	M16X1.0	17	G1/8	30.8	6.8
PMF8-02G		10	9.8		32.6				G1/4	38.2	
PMF8-03G		11	9.8		33.6				G3/8	51.2	
PMF10-02G	10	10	11.8	5	36	20.9	M20X1.0	21	G1/4	59	8.5
PMF10-03G		10	11.8		36				G3/8	68	
PMF12-03G	12	10	13.8	5	38.7	24.3	M22X1.0	24	G3/8	73.1	10.5
PMF12-04G		14	13.8		42.7				G1/2	71.8	

標準接頭 (白) Tube Fitting (Ivory)

PMF
G

分隔內牙直型
Bulkhead Female Straight

\$ P06

3D
CAD

2D
CAD

單位(Unit): m/m

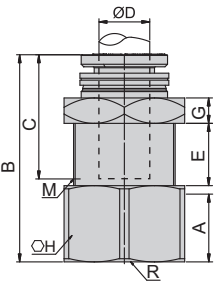

Model 型式	Tube dia. ØD 管外徑	A	E	G	B	C	M	H	R	Mass(g) 重量	Orifice 流量孔徑
PMF4-01G-W	4	8	5.9	4	25.2	12.4	M12x1.0	14	G1/8	18.8	3
PMF6-01G-W	6	9	7.8	4	28.8	14.3	M14x1.0	17	G1/8	29.5	4.8
PMF6-02G-W		10	7.8		29.8				G1/4	29	
PMF8-01G-W	8	9	9.8	4	31.6	18.3	M16x1.0	17	G1/8	30.8	6.8
PMF8-02G-W		10	9.8		32.6				G1/4	38.2	
PMF8-03G-W		11	9.8		33.6				G3/8	51.2	
PMF10-02G-W	10	10	11.8	5	36	20.9	M20x1.0	21	G1/4	59	8.5
PMF10-03G-W		10	11.8		36				G3/8	68	
PMF12-03G-W	12	10	13.8	5	38.7	24.3	M22x1.0	24	G1/4	73.1	10.5
PMF12-04G-W		14	13.8		42.7				G3/8	71.8	

PMF
G+NI

分隔內牙直型
Bulkhead Female Straight

\$ P06

3D
CAD

2D
CAD

單位(Unit): m/m

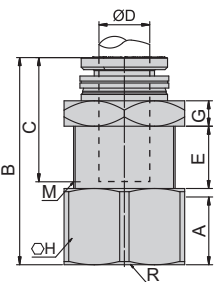

Model 型式	Tube dia. ØD 管外徑	A	E	G	B	C	M	H	R	Mass(g) 重量	Orifice 流量孔徑
PMF4-01G-NI	4	8	5.9	4	25.2	12.4	M12x1.0	14	G1/8	19	3
PMF6-01G-NI	6	9	7.8	4	28.8	14.3	M14x1.0	17	G1/8	30.5	4.8
PMF6-02G-NI		10	7.8		29.8				G1/4	30	
PMF8-01G-NI	8	9	9.8	4	31.6	18.3	M16x1.0	17	G1/8	31.9	6.8
PMF8-02G-NI		10	9.8		32.6				G1/4	39.2	
PMF8-03G-NI		11	9.8		33.6				G3/8	53.9	
PMF10-02G-NI	10	10	11.8	5	36	20.9	M20x1.0	21	G1/4	63.5	8.5
PMF10-03G-NI		10	11.8		36				G3/8	70	
PMF12-03G-NI	12	10	13.8	5	38.7	24.3	M22x1.0	24	G1/4	76.8	10.5
PMF12-04G-NI		14	13.8		42.7				G3/8	75.5	

備註 Note NI: 金屬脫離環

NI: Release Ring (Metallic Body)